

Appendix 3

Request for CIL Funding with regard to Members Items for Area Committee

Title	Physic Well – Lighting and Information Board
Raised by (Councillor)	Councillor Stephen Sowerby (Design & Heritage Champion)
Ward	The Physic Well is located in Underhill ward
Area Committee	Chipping Barnet Area Committee
Member Request	<p>Background The Physic Well is a Grade II listed structure within which spring water is collected in a subterranean 17th century vault. This water was used by the public for medicinal purposes in the 17th and 18th century. The mock Tudor building surrounding the Well was erected by Barnet Urban-District Council in 1937. The whole structure including the well vault has experienced no significant refurbishment since its construction causing the building to fall into disrepair and being put on Historic England's risk register. In 2017 a financial partnership with Historic England was agreed to refurbish the well for educational purposes, including schools and community groups, the wider public and to preserve the Borough's heritage. The refurbishment works commenced in April 2018 and include the installation of a drainage system.</p> <p>Unfortunately, the refurbishment costs have overrun and the original allocated budget of approximately £117,000 has not proven sufficient for the Well's lighting and electrical requirements. This is because the extent of the rotted timber frames was not fully captured by the initial condition survey (the rotting was because the building had not had a drainage system installed in 1937). Historic England and Heritage of London Trust do not fund lighting costs and information boards. A CIL funding request is now being made to meet these costs, vital for public accessibility.</p> <p>Funding request: Lighting The building does not currently have lighting, so it is proposed to install lighting on both the ground floor and subterranean area (the well vault).</p> <p>The funding request is for:</p> <ul style="list-style-type: none"> - A bulkhead lighting fixture in the vault - Concealed LED lighting beneath the handrail of the stairwell - Associated wiring works to enable the above - Smoke detectors

- Power installation conduit
- Lighting Install Conduit Ground Floor
- Lighting Supply
- Total: £14,645.82 (not including VAT)

The lighting proposals have been put together by a heritage consultant (a requirement of Historic England), after discussion with the Council's project manager and Councillor Sowerby. The lighting proposals have been designed to enhance visitor experience and are compatible with the historic building.

Images of the proposed lighting are shown below:

Example general light black twin:

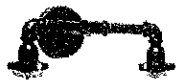

Example bulkhead lighting for the vault area:

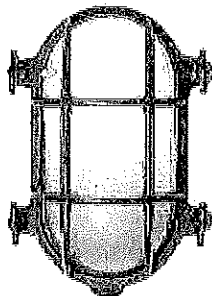

Funding request: Information Board

It is proposed that Barnet Museum will open the Physic Well to the public. It is proposed to install an information board outside of the Physic Well. The information board will inform the public of this historic building, and will be particularly useful when the building is closed.

A draft mock-up of the information board is shown below -

BARNET PHYSIC WELL

History of the Physic Well

The date that the Barnet mineral spring was first discovered is unrecorded. It is likely that the well was used by local Barnet people living near it on Barnet Common many centuries before it was 'discovered' by the Tudor guidebook writer William Camden in the late sixteenth century and publicised by celebrities like Samuel Pepys in the seventeenth. Country people were always seeking 'good' sources of water for their animals. They also looked to their local wells and springs to provide cures for illnesses since they could not afford doctors' fees. There must have been successful 'cures' in the sixteenth century, because the water was then thought to be very good for colds and fevers.

Visit of Samuel Pepys

According to his famous diary Barnet Physic Well received its most important visitor, Samuel Pepys, on 11 July 1664. He did not journey from London just to visit the Well, but was dining in Barnet and decided to ride the extra half mile over Barnet Common to the well:

"...there I drunk three glasses and went and walked, and came back and drunk two more. The woman would have had me drunk three more; but I could not, my belly being full - but this wrought me very well; and so we rode home... and my waters working at least seven or eight times upon the road, which pleased me well".

Pepys returned to the Well three years later, on Sunday 11 August 1667 at 7am when he found there 'many people a-drinking, but the morning is a very cold morning. This time he limited himself to three glasses.

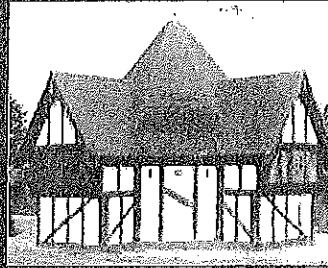

Inside the Well

In the seventeenth century, a subterranean brick chamber was built to collect the spring water. The spring water remained popular throughout the eighteenth century. The Well House itself was constructed above the spring water chamber by the Council in 1937, in a mock Tudor style. In 2018, the Well House was restored with support from the London Borough of Barnet, Historic England, and the Heritage of London Trust.

If you would like to see the inside of the Physic Well please contact www.barnetmuseum.co.uk

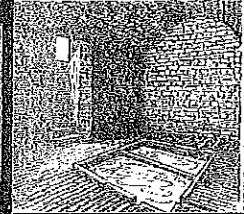
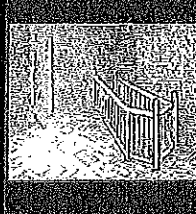

Historic England



HERITAGE of LONDON TRUST



BARNET MUSEUM

The quote received for a stove enamel sign is shown below. This material is particularly graffiti, scratch and weather-proof. This material has been proposed due to the location of the Physic Well, which is in a quiet residential area and a considerable distance away from a busy high street.

The quote (not including VAT) is:

Sign	£1350
Installation	£245
Total	£1595

Funding
Required
(£)

£16,240.82 not including VAT